

80 Kg/24h

K80

Fabbricatori di ghiaccio a cubetto cavo / Hollow cube Ice Makers:  
K23 nano - K23 - K25 - K30 - K36 - K45 - K50 - K62 - K80 - K95 - K150  
K23 nano F - K23 F - K25 F - K30 F - K36 F - K45 F - K50 F - K62 F - K80 F - K95 F - K150 F

230V/1N/50Hz  
Self contained - Paddle System

- USB
- BLUETOOTH
- WI-FI
- TOUCH CONTROL
- RAINBOW TECHNOLOGY
- SAFE ICE
- PROGRAMMED OZONE CYCLE
- SCHEDULED PRODUCTION

## CARATTERISTICHE

- Scocca in acciaio
- Condensazione ad aria o acqua
- Ciclo di lavaggio
- Tasto comandi capacitivo
- Segnalazione acustica e luminosa allarmi
- Report allarmi HACCP
- Regolazione livello ghiaccio deposito
- Collegamento USB per aggiornamento sw e scarico dati HACCP
- Ventilatore condensatore controllato alle basse temperature ambiente
- Analisi predittiva malfunzionamenti
- Report prestazioni apparecchiatura
- Kit piedini 100 mm

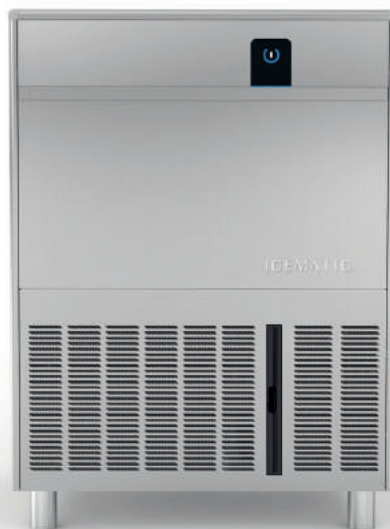

## TIPO GHIACCIO / ICE TYPE

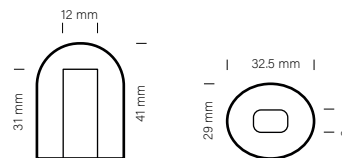

PCS / CYCLE  
PZ/CICLO 60

WEIGHT ICE  
PESO GHIACCIO 21 g

PRODUZIONE GHIACCIO /  
ICE PRODUCTION kg/24h  
lbs/24h

## OPZIONALE

- Ciclo sanificazione programmabile con Ozono
- Trattamento nanotecnologico evaporatore con Rainbow technology
- Connessione cloud IOT
- Produzione ghiaccio programmabile

Raffreddamento ad Aria  
Air Cooled Unit

Temp. Aria Air Temp.	Temp. Acqua / Water Temp.			
°C	32°	21°	15°	10°
°F	90°	70°	60°	50°
10°	<b>65</b>	<b>74</b>	<b>77</b>	<b>80</b>
50°	143	163	170	176
21°	<b>60</b>	<b>68</b>	<b>71</b>	<b>73</b>
70°	132	150	157	161
32°	<b>48</b>	<b>54</b>	<b>56</b>	<b>57</b>
90°	106	119	123	126
38°	<b>40</b>	<b>44</b>	<b>46</b>	<b>47</b>
100°	88	97	101	104

## FEATURES

- Stainless steel construction
- Air or water condensation
- Cleaning cycle
- Touch control
- Acoustic and luminous alarms
- Report HACCP alarms
- Storage bin ice level adjustment
- USB connection for software update and HACCP data download
- Condenser fan controlled at low ambient temperatures
- Predictive analysis of malfunctions
- Machine performance report
- Feet 100 mm kit

## CAPACITÀ DEPOSITO / BIN CAPACITY

36 kg 1714 pcs

## DIMENSIONI / DIMENSIONS

L x P x H (mm)  
 700 x 585 x 956  
 760 x 640 x 1050

## VOLTAGE

220-240/50/1  
220/60/1

## GAS

R290  
GWP=3  
Ton CO2 equiv. Air = 0.0  
Ton CO2 equiv. Water = 0.0

## OPTIONAL

- Ozone sanitization cycle programmable
- Rainbow technology : Nanotechnological evaporator treatment
- IOT cloud connection
- Programmable ice production

## DATI TECNICI - SPECIFICATIONS

			cond	comp. W	ABS. W	Fuse	Kwh/100Kg	l / h	kg	kg
K80	A AG	220-240/50/1		1054	510	10	19.8	6.57	56	65
K80	W AG	220-240/50/1		1054	450	10	12.1	52.6	56	65

Raffreddamento ad Acqua  
Water Cooled Unit

Temp. Aria Air Temp.	Temp. Acqua / Water Temp.			
°C	32°	21°	15°	10°
°F	90°	70°	60°	50°
10°	<b>66</b>	<b>75</b>	<b>78</b>	<b>81</b>
50°	146	165	172	179
21°	<b>64</b>	<b>70</b>	<b>75</b>	<b>77</b>
70°	141	154	165	170
32°	<b>61</b>	<b>68</b>	<b>72</b>	<b>74</b>
90°	134	150	159	163
38°	<b>56</b>	<b>64</b>	<b>68</b>	<b>70</b>
100°	123	141	150	154

Via del Lavoro, 9 31033 Castelfranco Veneto (TV) Tel.  
+39 0423.738452 Fax +39 0423.722811  
email: info@castelmac.it  
www.castelmac.eu - www.icematic.eu

**80 Kg/24h**

K80

Fabbricatori di ghiaccio a cubetto cavo / Hollow cube Ice Makers:  
K23 nano - K23 - K25 - K30 - K36 - K45 - K50 - K62 - K80 - K95 - K150  
K23 nano F - K23 F - K25 F - K30 F - K36 F - K45 F - K50 F - K62 F - K80 F - K95 F - K150 F

230V/1N/50Hz  
Self contained - Paddle System

## DIMENSIONI - DIMENSIONS

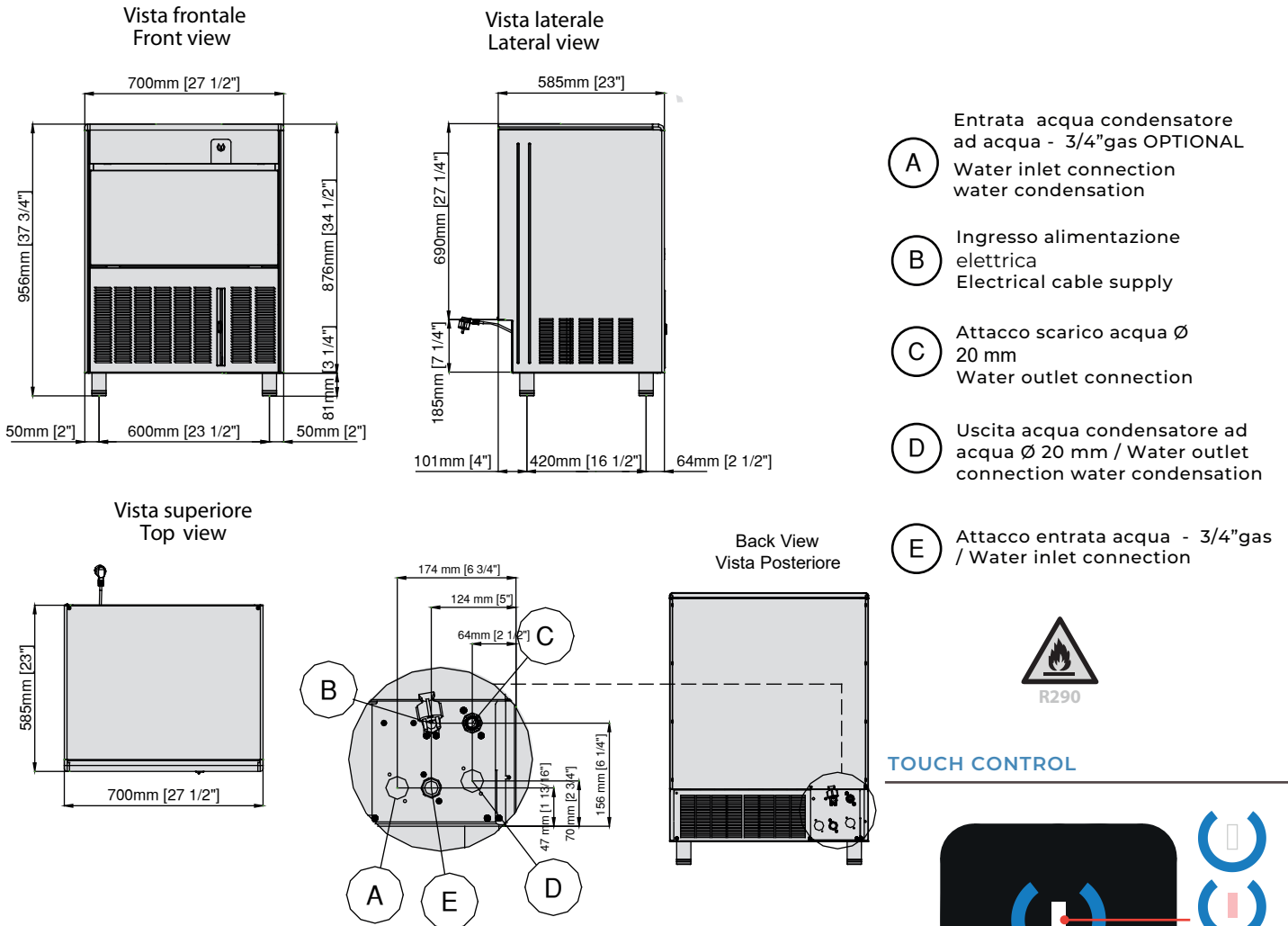

## APP ALLGAS SYSTEM

Permette il comando e il monitoraggio dei produttori di ghiaccio direttamente da smartphone / It allows the control and monitoring of the ice machines directly from a smartphone

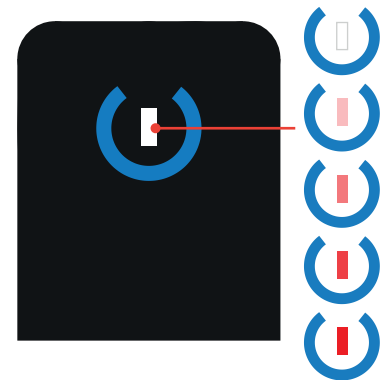
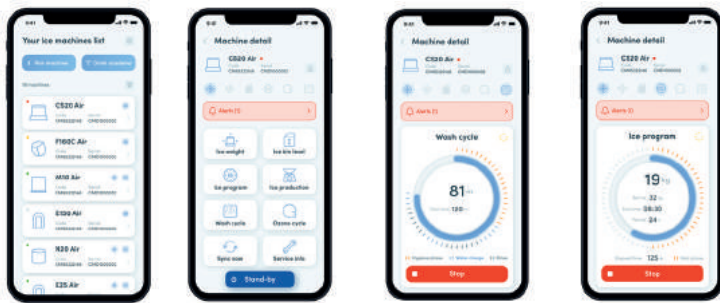

**Capacitive Stand-by Reset control**  
(led with continuous colors variation from white to red)

**Pulsante Capacitivo di ripristino dello stand-by** (led a variazione continua di colori dal bianco al rosso)

### Condizioni operative - Operating requirements

	Min.	Max
Temp. Ambiente / Air Temperature	10°C	40°C
Temp. Acqua / Water Temperature	5°C	35°C
Press. Acqua / Water Pressure	1 Bar (14psi)	5 Bar (70psi)
Conducibilità acqua / Water conductivity		> 10 µS
Alimentazione / Electrical supply	-10%	+10%

Calore espulso / Rejected Heat	1537 W
Volume Aria / Air Volume	500 m³/h

Via del Lavoro, 9 31033 Castelfranco Veneto (TV) Tel.  
+39 0423.738452 Fax +39 0423.722811  
email: info@castelmac.it  
www.castelmac.eu - www.icematic.eu